



**CONTECMA C.S. GmbH**  
worldwide

**Centrifuges Service**



**CONTECMA C.S. GmbH**

Your competent partner all around the centrifuge



# Organisation

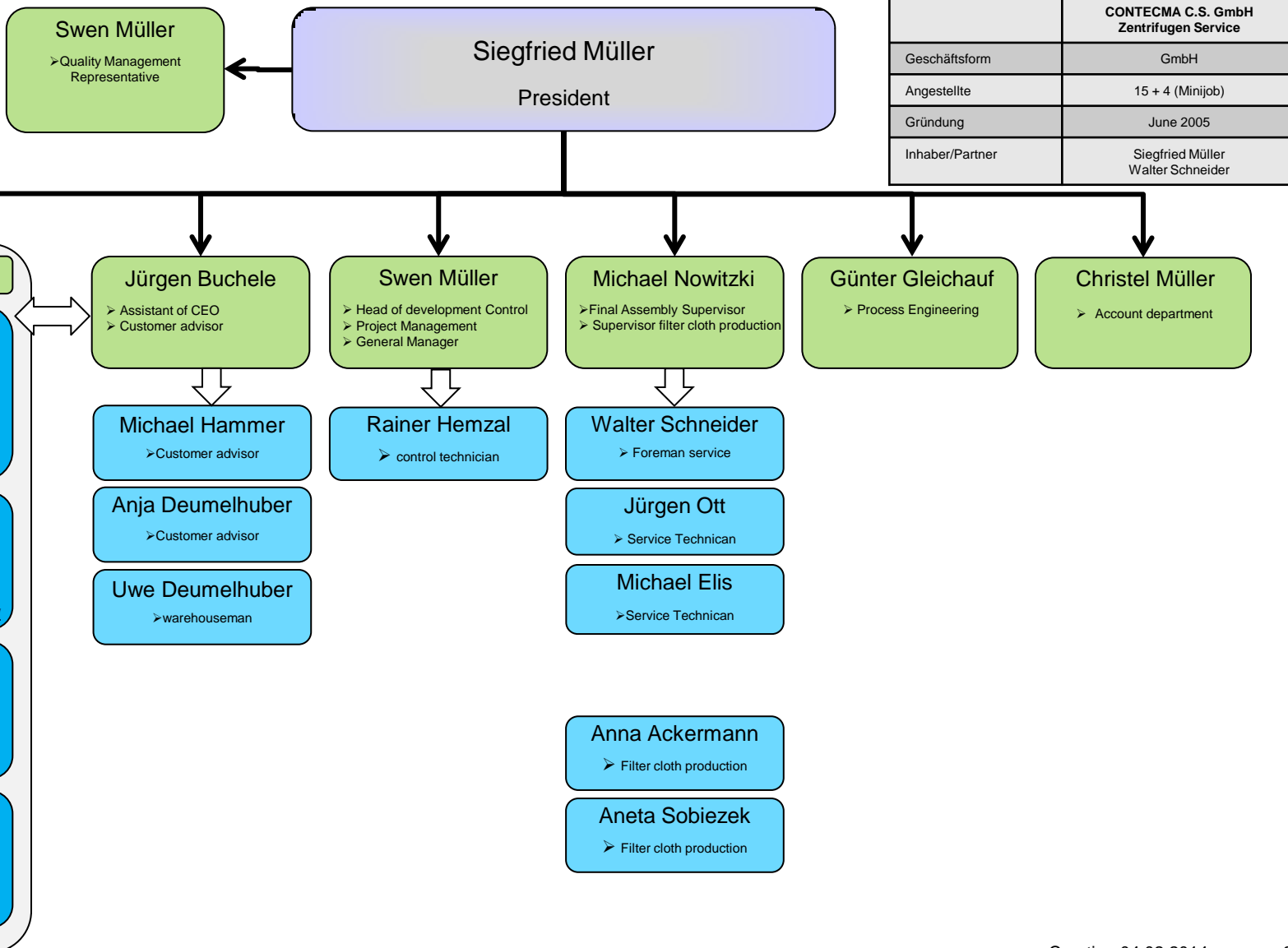

CONTECMA C.S. GmbH Zentrifugen Service	
Geschäftsform	GmbH
Angestellte	15 + 4 (Minijob)
Gründung	June 2005
Inhaber/Partner	Siegfried Müller Walter Schneider



# Our competence is your advantage



## Mr. Siegfried Müller is in charge of the area of purchase and material management

Mr. Müller is provided with many years of experience as director of the areas of purchase and material management with the former HEINKEL AG. From the beginning he played a decisive role in the development of the Inverting Filter Centrifuge. By means of his global and comprehensive general view of the market in the field of high end quality of manufacturing parts , special steel processing, procurement of replacement parts for centrifuges, Mr. Müller may also offer your company reasonable and competitive solutions.



## Mr. Walter Schneider directs the area of assembly and service

Mr. Schneider is your competent partner in the area of assembly on the spot. You may profit from his more than 22 years of experience in the area of repairing, maintenance, inspection and testing from Inverting Filter Centrifuges of the HEINKEL AG product. By means of the many years of experience in the office work and field service, Mr. Schneider is provided with the corresponding knowledge to offer you at all times the economically sensible and efficient service solutions.



## Mr. Michael Nowitzki is in charge of the area of assembly, retrofits and modifications

Mr. Michael Nowitzki is your competent partner in the area of assembly, retrofits and mechanical modifications. You may profit from his more than 22 years of experience in the area of the assembly of Inverting Filter Centrifuges of the HEINKEL AG product. His specific knowledge in the mechanics and development of centrifuges and additional units, as for example the P.A.C- System (Hypercentrifugation) increases the service life and service quality of your centrifuges.



## Customer service, sales of spare and wearing parts, start-up, attempts

Mr. Buchele is due to his 20 year old experience, as technicians for process engineering attempts, as well as service technicians and deputy director of purchase and material management with the HEINKEL AG a further competent specialist in the service business. His knows the requirements of our customers just as well as from the supplier. It is thus a valuable addition in our proven and experienced team for the well-being of our customers.



## Mr. Swen Müller leads the area of control- and equipment technology

During his 6 years as an external employee Mr. Müller Junior has planned the controls for more than 30 Inverting Filter Centrifuge. His know-how in the area of Project planning, control technology and certification is a valuable enlargement in our proven and experienced team. Thus the Contecma C.S. Ltd is also able that to take over electrical service of the centrifuges.



## Our man for the service with the customer

With 19 years of experience with the service of the Inverting Filter Centrifuge is Mr. Ott a competent expert. He knows the requirements and the circumstances with the customer. His specific knowledge in the mechanics and development of centrifuges and additional units, increases the service life and service quality of your centrifuges.



# Range of performances



**HEINKEL** ✓  
Second-hand machine trade

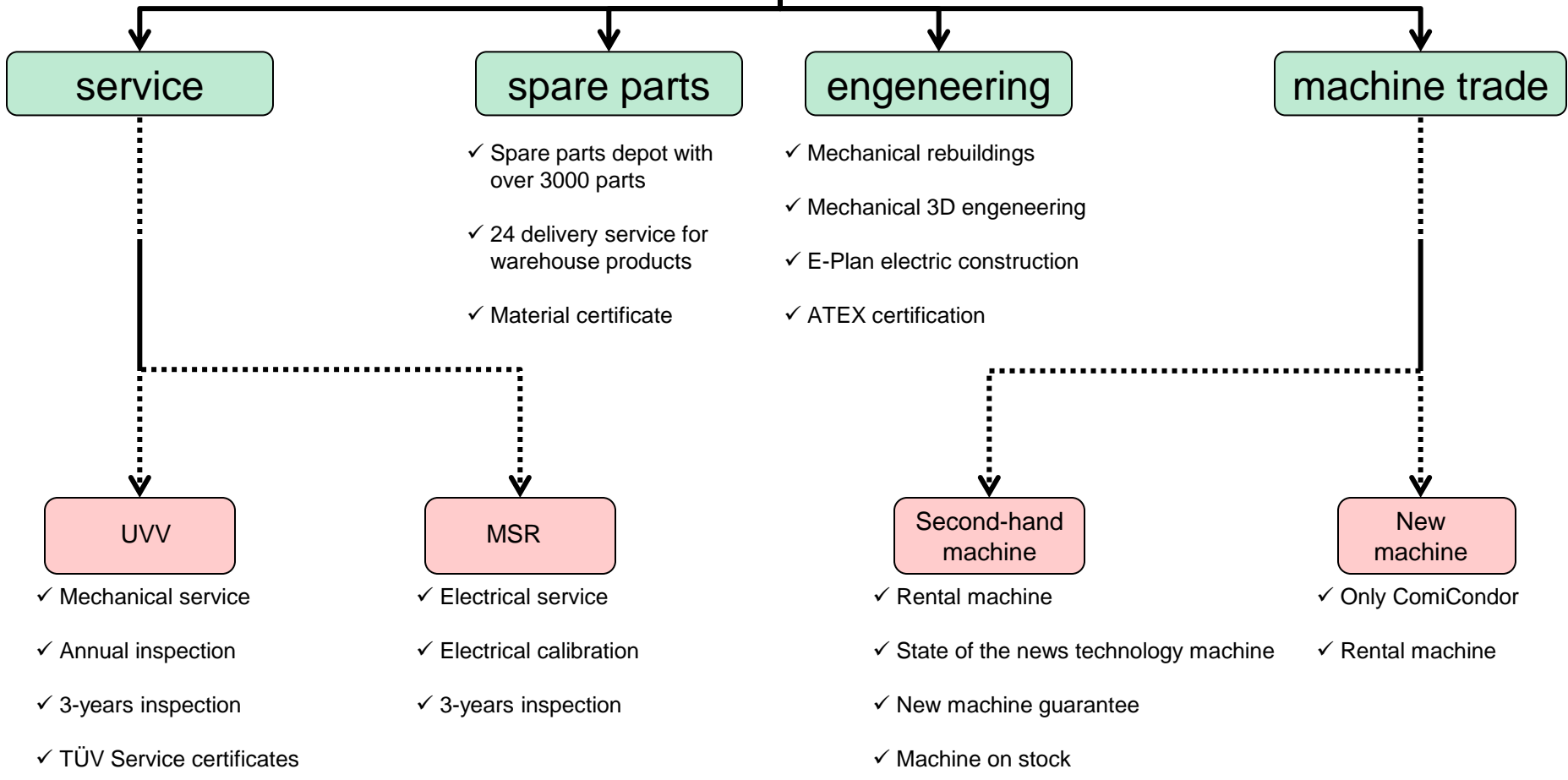



# Mechanical UVV Service

The European norm **EN 12547 “Centrifuges-General Safety Requirements”** as well as the directive **BGG “Basics of the testing of centrifuges by experts in accordance with the UVV, centrifuges, VBG 7z,”** demand for a regular inspection of centrifuges carried out by competent and trained maintenance staff.



## Annual inspection while in working condition

- ✓ Examination of the overall condition of the centrifuge
- ✓ Housings (solids housing as well as filtrate housing) dye penetration test
- ✓ Ingoing and outgoing lines, connections (flexibility)
- ✓ Drive (among others V-belt, couplings etc.)
- ✓ Drum and shaft (abrasion and dye penetration test)
- ✓ Filter cloth
- ✓ Lubrication
- ✓ Hydraulic aggregate (if existent)
- ✓ Exchange of the O-rings at the housings and the Teflon band
- ✓ Exchange of the mostly required O-rings (area basket with drum)
- ✓ Testing of the measuring instruments (pressure/flow)

## 3-years Inspection in disassembled condition

- ✓ Examination of the overall condition of the centrifuge
- ✓ Housings (solids housing as well as filtrate housing) dye penetration test
- ✓ Ingoing and outgoing lines, connections (flexibility)
- ✓ Drive (among others V-belt, couplings etc.)
- ✓ Filter cloth
- ✓ Lubrication
- ✓ Hydraulic aggregate (if existent)
- ✓ Exchange of the O-rings of the housings and the Teflon band
- ✓ Testing of the measuring instruments (pressure/flow)
- ✓ Exchange of the product-contacted O-rings and the Teflon band
- ✓ Disassembly of the shaft
- ✓ Exchange of the O-rings and seals of the bearing case
- ✓ Exchange of the seals
- ✓ Exchange of the shaft bearings



# Electrical MSR Service

**CONTECMA C.S. GmbH**  
 worldwide Centrifuges Service

## MSR Service

- ✓ Functional test of the actuators
- ✓ Functional test of the sensors
- ✓ Functional test of the temperature sensors
- ✓ Functional test of the vibration measurement
- ✓ Functional test of the safety chain
- ✓ Functional test of the pressure sensors
- ✓ Calibration of the load cell
- ✓ Review of the software-steered functional expiries
- ✓ Electrical insulation test
- ✓ Leakage test
- ✓ View control of the cables and connections

### MSR Service points of HEINEL HF600 Centrifuge

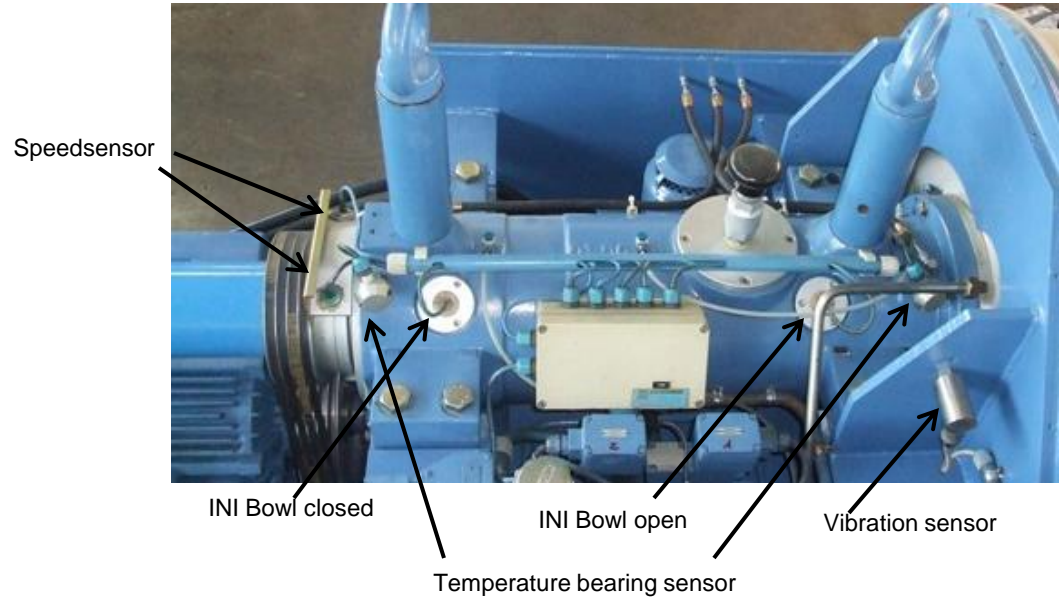

load cell



Limit switch Filtrate Housing open



Limit switch Filtrate Housing closed



# Spare parts



Spare parts for a 3-years Inspection

- ✓ Big spare parts depot with over 3000 parts
- ✓ 24 delivery service for warehouse products
- ✓ FDA material certificate
- ✓ Supply of stainless steel and hastelloy parts
- ✓ Centrifuge bearing housing for HEINKEL HF600 and HF800 on stock
- ✓ Delivery of electric spare parts, S5 & S7 controls
- ✓ Delivery of Centrifuge filter cloth
- ✓ Supply of centrifuge housing, shafts and drums



Manufacture shares in the warehouse



Filter cloth for Centrifuges

CONTECMA C.S. runs a **spare part stockroom** for the worldwide trade with replacement and wearing parts. This guarantees the immediate availability of replacement parts for you. Our replacement parts management is orientated towards the high expectations of our customers in the chemical and pharmaceutical industry. For this reason we have solved the problem of immediate delivery of typical wearing parts effectively for you. With regard to long-lasting parts, housings, shafts and drums we are working on a pure order basis at present.



# Engineering

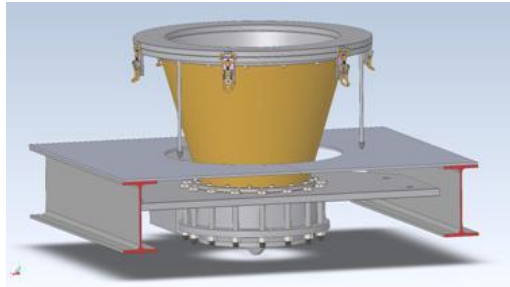

SolidWorks 3d engineering

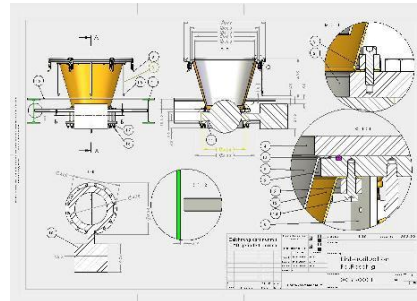
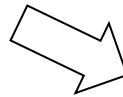

Design and manufacturing drawing

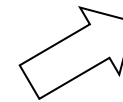

Manufactured discharge system

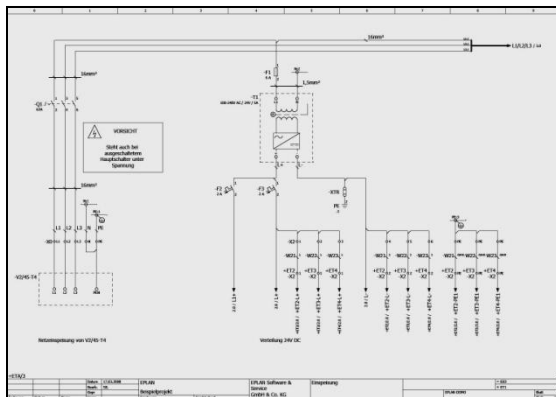

EPLAN P8 engineering

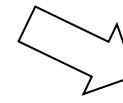
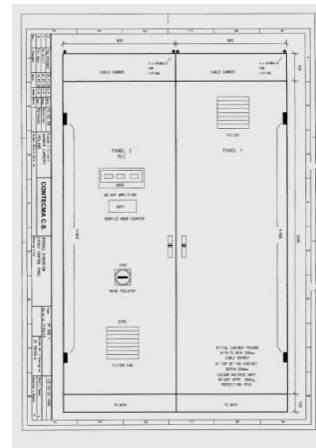
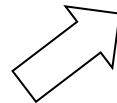

Manufactured inverter cabinet





# rebuilding



Replacement of a centrifuge instrumentation according to ATEX



Replacement of a filling control system



Centrifuge discharge system



Adapter of basket and drum

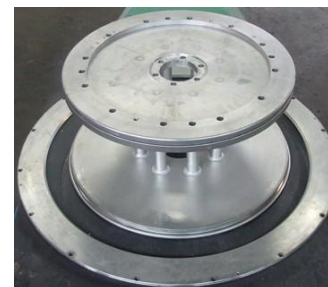

Supply a drum application

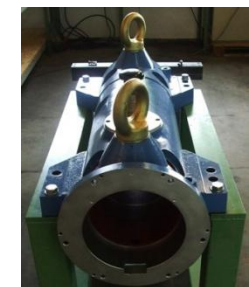

Overhaul of a bearing housing

- ✓ Exchange of a centrifuge instrumentation in accordance with ATEX
- ✓ Rebuild the PLC system of Siemens S5 on S7 control
- ✓ Manufacturing of a flexible, gastight discharge system with compensator, quick acting closures and barrel docking device
- ✓ Exchange of product-contacted static and rotating mechanical parts
- ✓ Modification of a stainless steel centrifuge into a Hastelloy centrifuge
- ✓ Sheet metal working and delivery of filtrate box (cyclone), filtrate housing, air circulation pipe and solids housing
- ✓ Supply of drum insert and drum
- ✓ Rebuilding of a centrifuge on a P.A.C. system



# P.A.C. System

PAC-System



- ✓ Exchange of the radial membrane on the seal head of the pressure feed pipe
- ✓ CONTECMA C.S. is equipped with a test stand and tested in a clean ambiance with regard to impermeability
- ✓ Mr. Nowitzki as expert he may support you in the further development and improvement of the serviceable life of this sensitive technology
- ✓ All size of spare membranes are permanently in stock in Viton black ,Viton light, EPDM and Kalrez
- ✓ All membranes with FDA certificate
- ✓ We overhaul and optimize your entire feed pipe
- ✓ We support an 3 days overhaul for your send sealing head



Old membrane

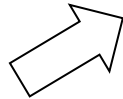

Sealing head with defective membrane

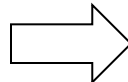
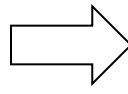
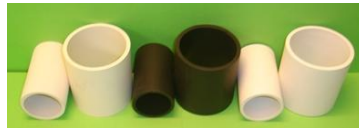
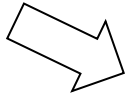

Replacement of a radial membrane on the sealing head

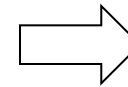

Sealing head with repaired membrane



# Machine trade

You need a new or second-hand machine?



We are the partner you need.



New or second-hand ComiCondor machine.

- ✓ Inverting Filter Centrifuge
- ✓ Peeler Centrifuge



Second-hand HEINKEL Inverting Filter Centrifuge.

- ✓ We deliver all sizes

- ✓ Our Second-hand machines have a New-machine guarantee
- ✓ We have different machines on stock
- ✓ You want to rent a machine? We can do this
- ✓ Our machines are general state of the news technology
- ✓ They want to sell her old machine? We make a good offer.



# The way from old to a new machine



Old HEINKEL centrifuge with the delivery



Dismantling up to the last screw



All single parts are new painted



Pickled of all product contacted parts



Overhaul the centrifuge bearing housing



And now we have a new machine



# Concept of the control

- ✓ Creating specifications
- ✓ R & I flow diagram
- ✓ Hardware Specification
- ✓ Functional Specification

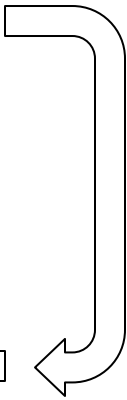
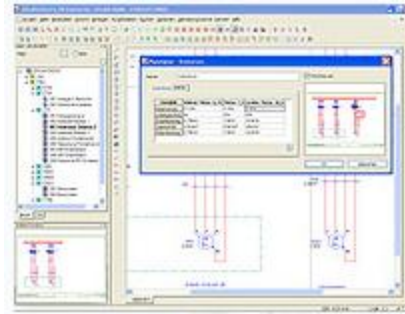

Electical design with E-plan P8

Construction of the cabinets



Start of operation by Contecma C.S.



Start of operation at the customer



**CONTECMA C.S. GmbH**  
worldwide Centrifuges Service



**Thank you for your attention**

**CONTECMA C.S. GmbH**  
worldwide Centrifuges Service

We are your competent partner also over 120  
years experience in the range centrifuge  
technology

For more information see also at [www.contecma-cs.de](http://www.contecma-cs.de)

CONTECMA C.S. GmbH  
Siemensstraße 23  
D- 74343 Sachsenheim  
Tel.: +49 (7147) 27697-0  
Fax.: +49 (7147) 27697-29  
Mail: [info@contecma-cs.de](mailto:info@contecma-cs.de)